

RECOMMENDED PCB LAYOUT (TOP VIEW)

**MATERIAL**  
 INSULATOR: GLASS-REINFORCED THERMOPLASTIC.  
 CONTACT: COPPER ALLOY.  
 PLATING: WELDING AREA - SELECTED GOLD OVER NICKEL.  
 SOLDER AREA - TIN/LEAD OVER NICKEL.

**ELECTRICAL**  
 VOLTAGE RATING: 250 VAC RMS.  
 CURRENT RATING: 1 AMP.  
 DELTA I: WITHSTANDING VOLTAGE: 500 VAC RMS @ 50 HZ FOR 1 MINUTE.  
 INSULATION RESISTANCE: 1000 MEGOHMS MIN AT 500 VDC.  
 CONTACT RESISTANCE: 30 MILLIOHMS MAX.

**MECHANICAL**  
 RETENTION FORCE: 480 GRAMS MIN PER CONTACT PAIR.  
 INSERTION FORCE: 230 GRAMS MAX PER CONTACT PAIR.  
 WITHDRAWAL FORCE: 15 GRAMS MIN PER CONTACT PAIR.  
 ENVIRONMENTAL  
 TEMPERATURE RANGE: -55°C TO +85°C.

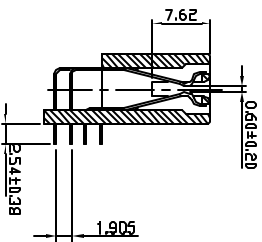

TOLERANCE		Sullins Electronics San Marcos, CA www.SullinsElectronics.com	TITLE: 64 BIT PCI CONN , 3.3V TYPE RIGHT ANGLE
LINEAR	ANGLES		
X ± 0.20	X ±	APPR:	PART NO. TRWB0920KAN-1329
X ± 0.15	X ±	CHKD:	DWG NO. 1329
X ± 0.10	.XX ±	FINISH:	UNITS MM
.XXX ±	.XXX ±	QTY:	SCALE 2 : 1
			SHEET 1 OF 1
			REV A

REV	ECN NO.	NAME	DATE
A	0601	Jason	90.06.01
			XXXX.05

1 2 3 4 5 6 7 8

E D C B A

1 2 3 4 5 6 7 8