

THIS COPY IS PROVIDED ON A RESTRICTED BASIS AND IS NOT TO BE USED IN ANY WAY DETRIMENTAL TO THE INTERESTS OF PANDUIT CORP.

PANDUIT PART NUMBER	WIRE SIZE AWG [mm ²]	STUD SIZE		HOUSING COLOR	DIMENSIONS - in. [mm]						WIRE STRIP LENGTH in [mm] +1/32 [0,8] -0	TOOLS
		ENGLISH	METRIC		L± .04 [1,1]	W± .01 [0,3]	C± .02 [0,5]	M± .03 [0,8]	H ^{+.02 [0,4]} -0	B		
EV18-14FB	#22-16 [0,5-1,5]	1/4"	M6	RED	.83 [21,0]	.37 [9,5]	.26 [6,5]	.39 [10,0]	0.25 [6,4]	.145 [3,7]	9/32 [6,8]	KST2000A
EV14-14FB	#16-14 [1,5-2,5]	1/4"	M6	BLUE	.83 [21,0]	.37 [9,3]	.26 [6,5]	.39 [10,0]	0.25 [6,4]	.165 [4,2]	9/32 [6,8]	
EV10-56FB	#12-10 [4,0-6,0]	5/16"	M8	YELLOW	1.20 [30,5]	.55 [14,0]	.41 [10,5]	.51 [13,0]	0.33 [8,4]	.240 [6,1]	11/32 [8,8]	

NOTES:

- UL LISTED FOR:
 - A. STRANDED COPPER WIRE ONLY (EV14-14FB & EV10-56FB)
 - B. SOLID OR STRANDED COPPER WIRE ONLY (EV18-14FB)
 - B. 221°F (105°C) MAX TEMP RATING
 - C. 600V MAX VOLTAGE RATING
- MATERIAL:
 - A. STAMPING - COPPER, TIN PLATED:
 - EV18-14FB: .030" [0,75] THICK
 - EV14-14FB: .031" [0,8] THICK
 - EV10-56FB: .039" [1,0] THICK
 - B. HOUSING - VINYL
- SEE WWW.PANDUIT.COM FOR PACKAGE QUANTITIES
- DIMENSIONS IN BRACKETS ARE METRIC EQUIVALENT

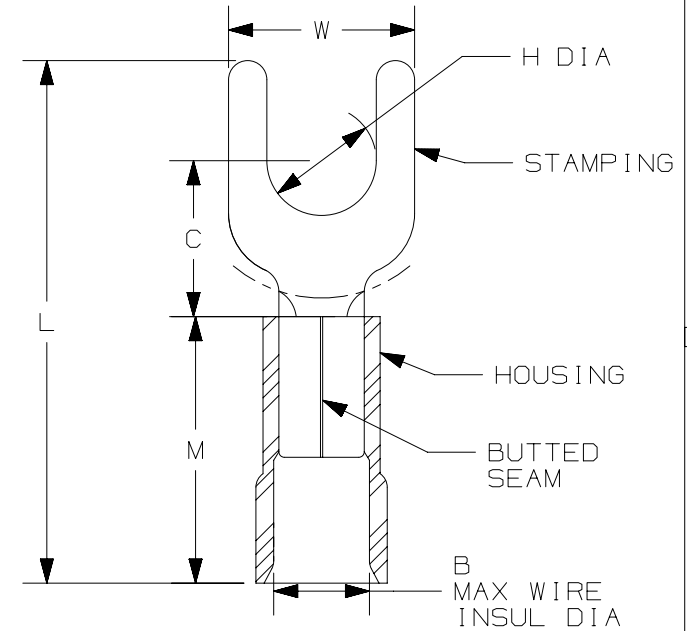

TITLE		STRONGHOLD FORK TERMINALS VINYL INSULATED, BUTTED SEAM #22-10 AWG	
CUSTOMER DRAWING			
ITEM REVISION NAME	00123SSK/00	PANDUIT TM	
DATASET FILE NAME	00123SSK_DC/00		
UNLESS OTHERWISE SPECIFIED, DIMENSIONAL TOLERANCES ARE: IN [mm]		MATERIAL: SEE NOTES	
.X ± .XXX ± .XX ± ANGLES ±		DRAWING NUMBER: 00123SSK - DC	
THIRD ANGLE PROJECTION			
DRAWN BY	DATE	CHK	SCALE
FES	-	FES	N.T.S.
SHEET 1 OF 1		SIZE A	

REV	DATE	BY	CHK	APR	DESCRIPTION	ECN
00	2/18	JHNU	TMR	RGB	DRAWING RELEASED	00123SS

D101000DA/12